

ZARN2052-L-TV

Needle roller/axial cylindrical roller bearing

Schaeffler ID:
0016819580000

Needle roller/axial cylindrical roller bearings ZARN..-L, double direction, long shaft locating washer

Technical information

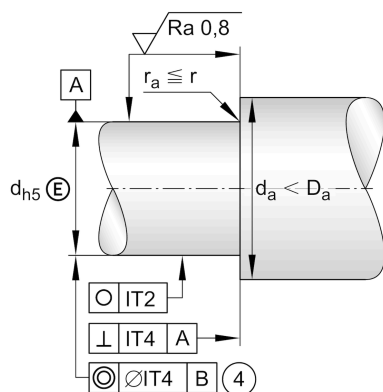
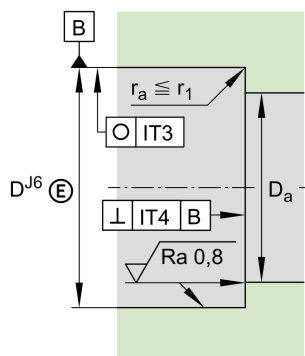
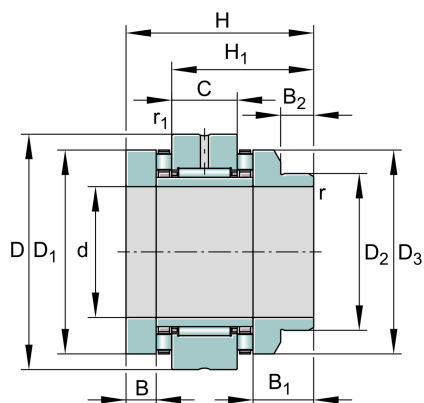

Main Dimensions & Performance Data

d	20 mm	Bore diameter
D	52 mm	Outside diameter
H	60 mm	Height
C _a	33.500 N	Basic dynamic load rating, axial
C _{0a}	76.000 N	Basic static load rating, axial
C _r	14.900 N	Basic dynamic load rating, radial
C _{0r}	22.400 N	Basic static load rating, radial
C _{ua}	6.400 N	Fatigue load limit, axial
C _{ur}	3.400 N	Fatigue load limit, radial
n _{G Oil}	7.000 1/min	Limiting speed for oil lubrication
n _{G Grease}	2.000 1/min	Limiting speed for grease lubrication
M _{RL}	0,5 Nm	Bearing friction torque
	0,45 kg	Weight

Mounting dimensions

D _{a max}	43 mm	Maximum diameter of housing shoulder
d _{a min}	28 mm	Minimum diameter shaft shoulder

Dimensions

H ₁	45 mm	Height outer ring over wave washer
C	16 mm	Width, outer ring
D ₁	42 mm	Rip diameter shaft washer
D ₂	42 mm	Heeldiameter wave washer long
D ₃	30 mm	Outside diameter wave washer long
B	10 mm	Width, inner ring
B ₁	24 mm	Width wave washer long
B ₂	12 mm	Width heel wave washer long
r _{min}	0,3 mm	Minimum chamfer dimension
r _{1 min}	0,6 mm	Minimum chamfer dimension

Temperature range

T_{\min}	-30 °C	Operating temperature min.
T_{\max}	120 °C	Operating temperature max.

Additional information

c_{aL}	1.800 N/μm	Rigidity axial
c_{kL}	230 Nm/mrad	Tilting stiffness
M_m	0,683 kg*cm ²	Mass moment of inertia
	1 μm	Axial runout
radial	ZMA20/38	Recommended INA precision locknut for radial locking (not included)
axial	AM20	Recommended INA precision locknut for axial locking (not included)
M_A	18 Nm	Tightening torque nut
	8.972 N	Required locknut force
	30X42X7	Rotary shaft seal to DIN 3760 (not included)